

SWING BRACKETS INSTALLATION

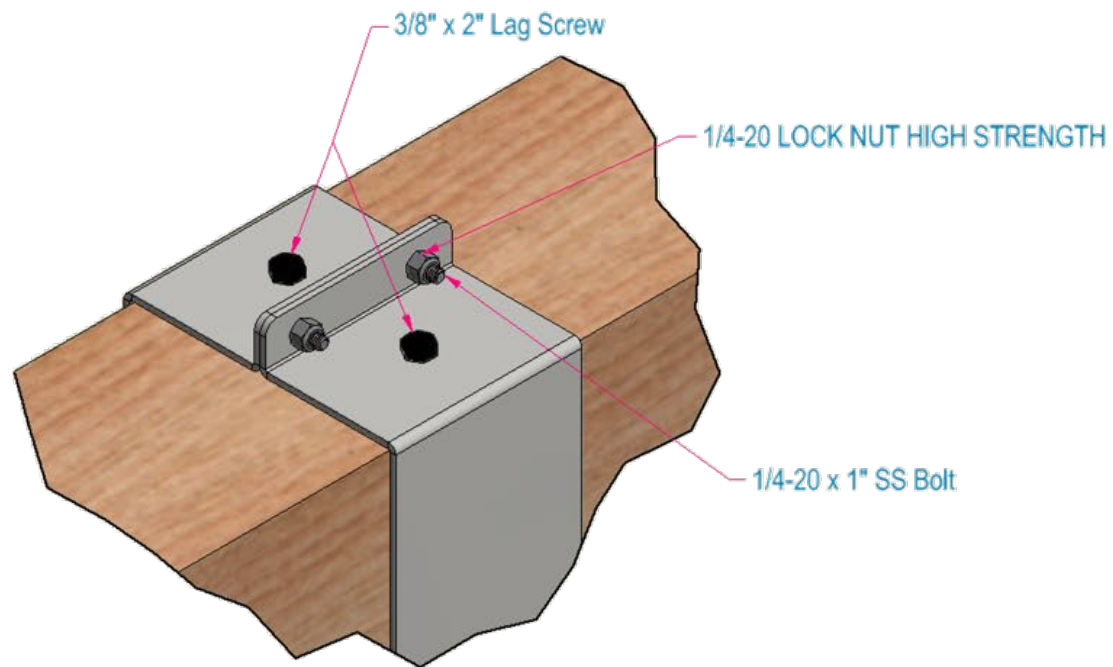

DETAIL A

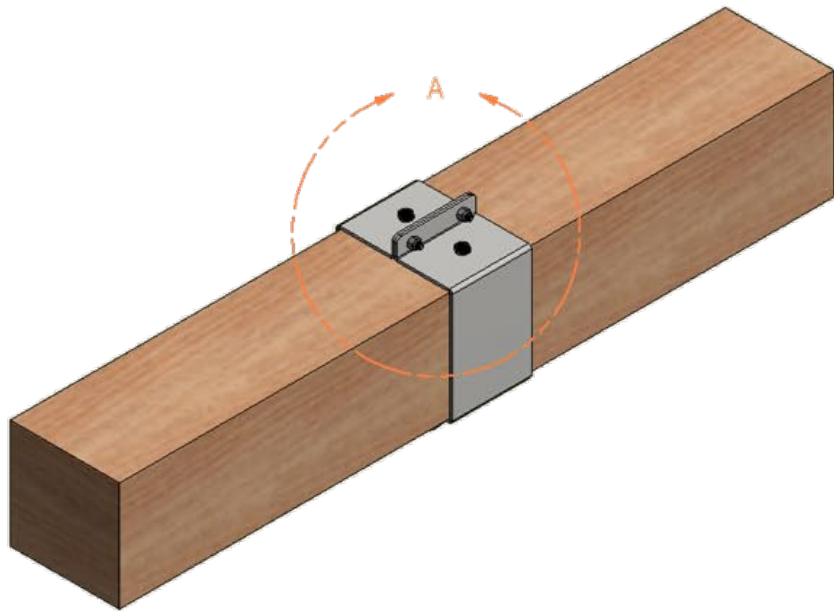
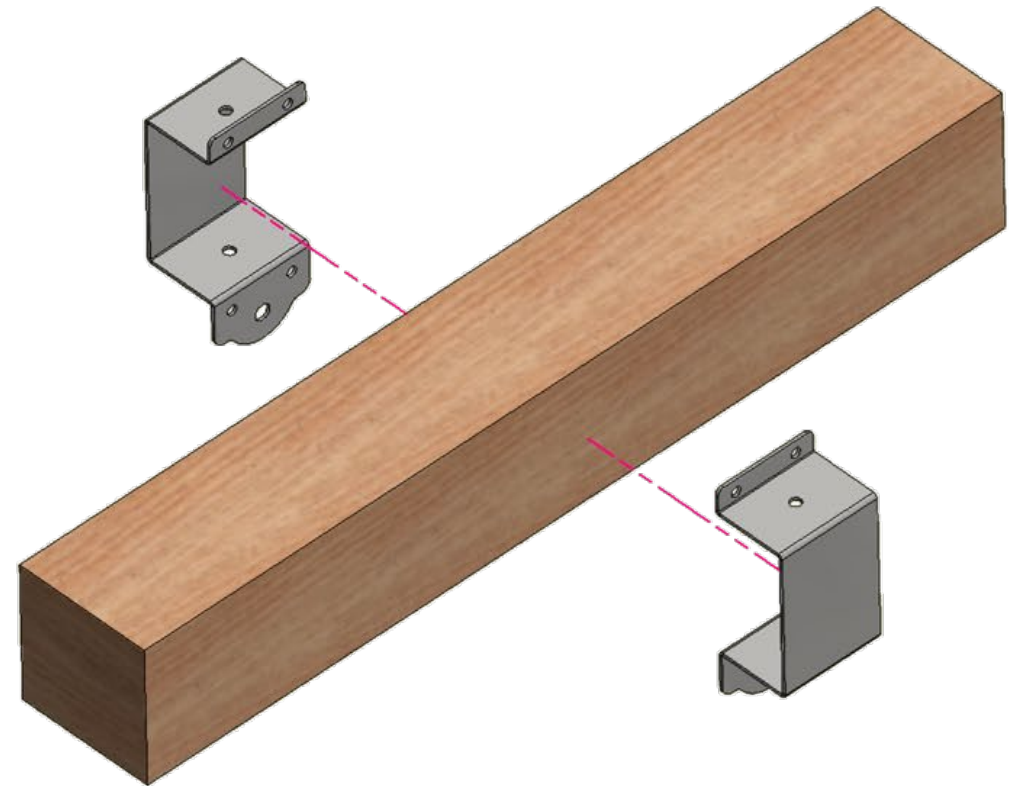

STEP 1
Slide Brackets over 6x6 Beam.

STEP 2:
Slide 1/4-20 x 1" bolt through top holes.
Hand tighten nuts.

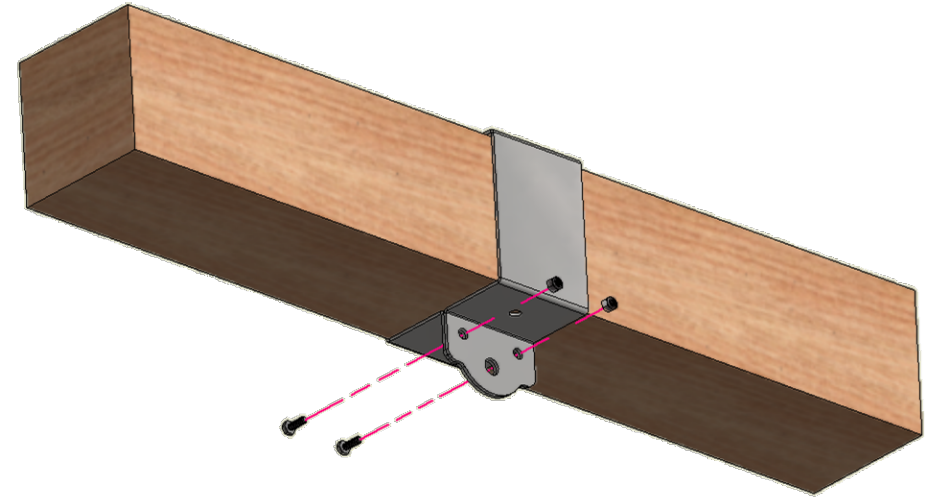
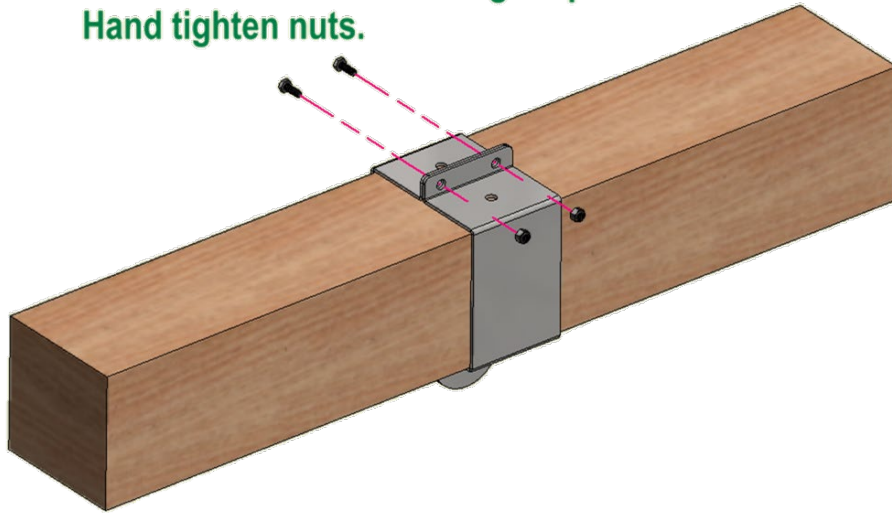

STEP 3:
Slide 1/4-20 x 1" bolt through bottom holes.
Hand tighten nuts.

STEP 4:
Hold screw head with a #2 Phillips Screw driver.
Tighten nuts using a 7/16" socket and ratchet.

STEP 5

**DRILL 3/16" X 2" pilot holes at the center of two holes on top.
Drive 3/8" x 2" lag screws into pilot holes and tighten using a 9/16" Socket and Ratchet.**

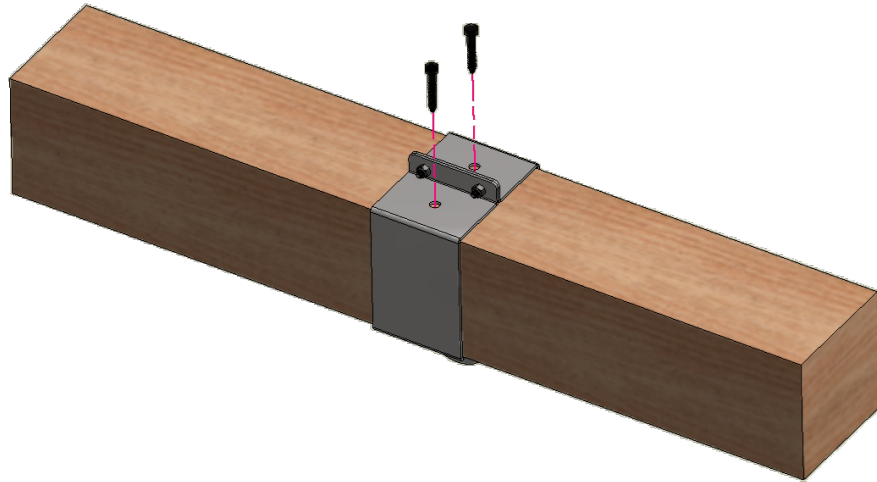

STEP 6

**DRILL 3/16" X 2" pilot holes at the center of two holes on the bottom.
Drive 3/8" x 2" lag screws into pilot holes and tighten using a 9/16" Socket and Ratchet.**

